

Notice



- ☐ CORRECTION ☒ PRODUCTION CHANGE
☐ SERVICE FLASH ☐ ADD INFORMATION

FILE NO.

REVISION 1

Please add this notice to the Service Manual listed below.

Category: COLOR TELEVISION	Date: MAY / 15 / 2001
Model: DS27510	Effective from: Chassis No. 27510-01
Destination: U.S.A.	REF: No. SS780035

NOTE: Match the Chassis No. on the unit's back cover with the Chassis No. in the Service Manual. **If the Service Manual Chassis No. does not match the unit's**, additional Service Literature is required. This chassis is similar to Chassis No. 27510-00. Only the **Difference** Service Information is given in this manual. For detailed Service Information, refer to the **Original** Service Manual and **Notices** for Chassis No. 27510-00 used in Model DS27510 (SS780035).

1. IN THE CHASSIS ELECTRICAL PARTS LIST

The reason for change.

- A : Misprint B : Quality Reliability C : Standardization
 D : Design E : Add as a possible sub F : Schematic location change
 G : Purchasing Request

Page & Section	Schematic Location		Part No.	Description	Q'ty	Interchange-ability	Reason
Page 13, Chassis Electrical Parts List	★C417	Old	403 349 3204 404 081 2708	MT-POLYPRO 0.3U J 250V MT-POLYPRO 0.3U M 200V	1	NO	D
		New	403 346 6723 404 081 2203	MT-POLYPRO 0.18U J 250V MT-POLYPRO 0.18U M 200V	1	NO	
Page 15, Chassis Electrical Parts List	★L413	Old	645 025 4413 645 029 8042	COIL, LINEARITY COIL, LINEARITY	1	NO	D
		New	645 025 4406 645 029 8035	COIL, LINEARITY COIL, LINEARITY	1	NO	

Parts list continued on back.

1. IN THE CHASSIS ELECTRICAL PARTS LIST (Continued)

The reason for change.

A : Misprint B : Quality Reliability C : Standardization
D : Design E : Add as a possible sub F : Schematic location change
G : Purchasing Request

Page & Section	Schematic Location		Part No.	Description	Q'ty	Interchangeability	Reason
Page 17, Chassis Electrical Parts List	★R421	Old	401 052 6505	MT-FILM 1K FA 1/6W	1	NO	D
		New	401 277 5208	MT-FILM 1.4K FA 1/6W	1	NO	
	★R497	Old	401 064 3806	OXIDE-MT 1 JA 2W	1	NO	D
		New	401 059 9608	OXIDE-MT 2.2 JA 1W	1	NO	
Page 19, Chassis Electrical Parts List	A100	Old	610 289 2802	ASSY, PWB, MAIN BRD	1	NO	D
		New	610 289 7419	ASSY, PWB, MAIN BRD	1	NO	
	★Q901	Old	414 009 7005	CRT A68ADT25X03	1	NO	D
		New	414 010 9500	CRT A68QDN891X003	1	NO	

For parts or service contact

SANYO Fisher Service Corporation
21605 Plummer Street
Chatsworth, CA 91311 (U.S.A.)
300 Applewood Crescent,
Concord, Ontario L4K 5C7 (CANADA)

FILE NO.

**SERVICE MANUAL
(SUPPLEMENT)**

**Remote Control Color
Television**

**DS27510 (U.S.A.)
(CANADA)
ORIGINAL VERSION**

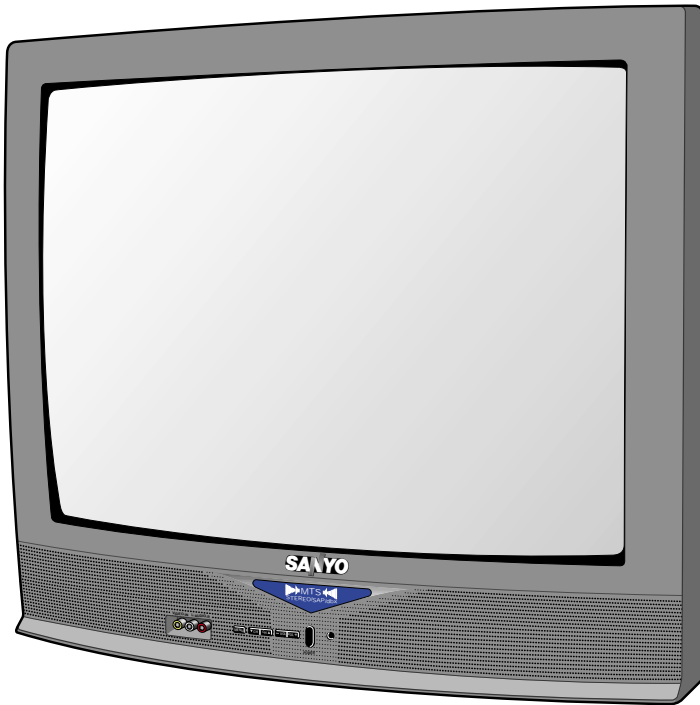

Chassis No. 27510-00

NOTE: Match the Chassis No. on the unit's back cover with the Chassis No. in the Service Manual.

If the Original Version Service Manual Chassis No. does not match the unit's, additional Service Literature is required. You must refer to "Notices" to the Original Service Manual prior to servicing the unit.

THIS CHASSIS IS SIMILAR TO MODEL AVM-2751S, CHASSIS NUMBER G7V-2751S0. SERVICE INFORMATION GIVEN IN THIS MANUAL IS ONLY THE DIFFERENCE INFORMATION FROM MODEL AVM-2751S, CHASSIS NUMBER G7V-2751S0. FOR ADDITIONAL SERVICE INFORMATION, REFER TO THE SERVICE MANUAL FOR CHASSIS NUMBER G7V-2751S0 USED IN MODEL AVM-2751S (SM780072).

DIFFERENCES

**MODEL DS27510 (Chassis No. 27510-00) — SAME AS MODEL AVM-2751S
(Chassis No. G5V-2751S0) EXCEPT:**

1. IN THE CABINET / ACCESSORY PARTS LIST

KEY NO.	MODEL AVM-2751S (Chassis No. G7V-2751S0)		MODEL DS27510 (Chassis No. 27510-00)	
	Part No.	Description	Part No.	Description
1	610 291 4726	CABINET FRONT ASSY	610 289 9313	CAB FRONT ASSY
11	610 293 2843	DEC SHEET	610 291 2678	DEC SHEET
	610 289 2925	OWNER'S MANUAL	610 289 3069	OWNER'S MANUAL
	645 044 3190	RC TRANSMITTER	645 044 3275	RC TRANSMITTER
	645 044 3237	RC TRANSMITTER	645 044 3305	RC TRANSMITTER

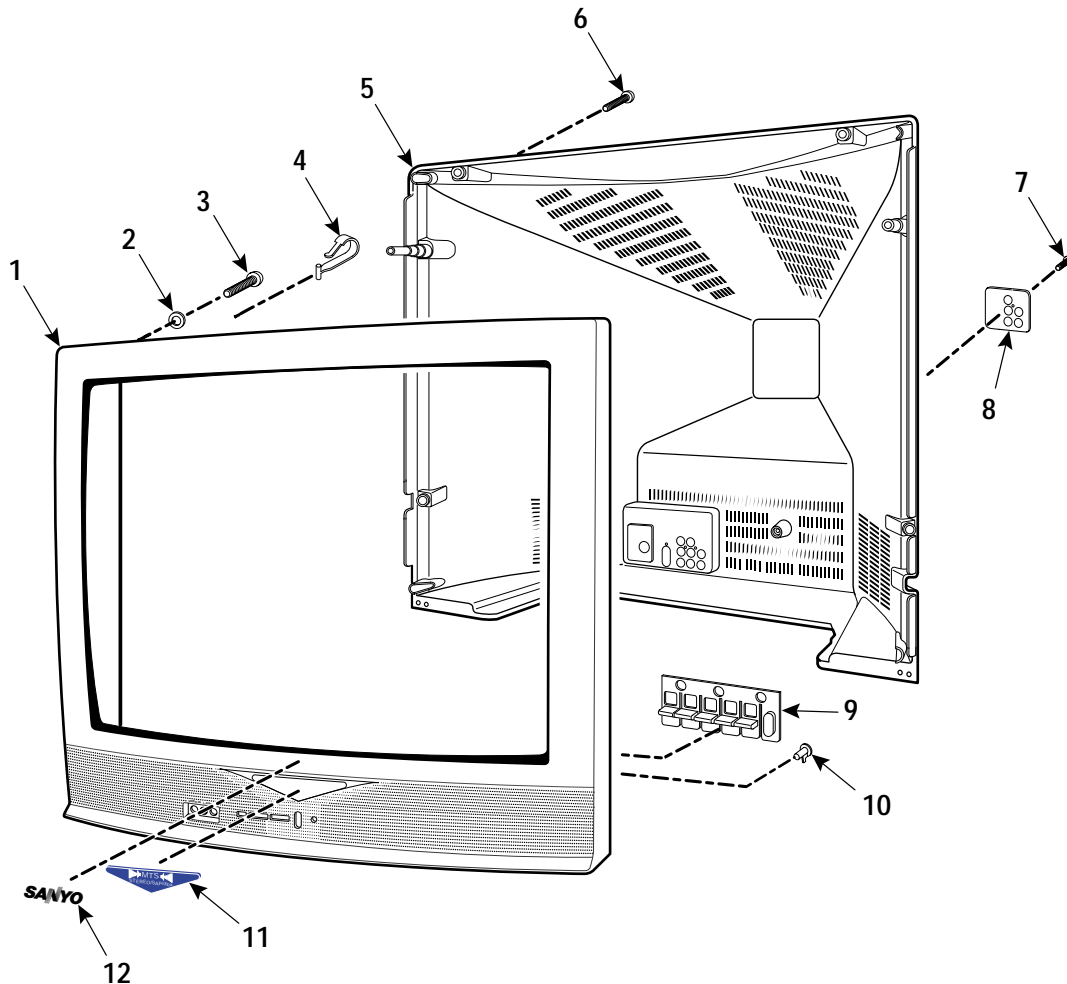

For parts or service contact

SANYO FISHER SERVICE

21605 Plummer Street
Chatsworth, CA 91311 (U.S.A.)

300 Applewood Crescent,
Concord, Ontario L4K 5C7 (CANADA)

May / 2001 / 2200 SMC

Printed in U.S.A.